



PT-PTC-D-BT

PoE to USB-C 60W Power and Data Adapter

Product Overview

PT-PTC-D-BT is an indoor PoE rated networking converter, special convert power&data from PoE to USB - C devices.

Our products provide the flexibility to install USB-C devices, quickly charge the device while enjoying a stable network, and plug in the cable without the need for cumbersome installation.

The PoE power supply is located up to 100 meters from the USB-C device. Provides 60W of USB power at the output of the adapter for mobile phones and tablets

Supports the PD2.0/3.0 charging protocol, encapsulated in an IP40 white plastic housing, small in size and easy to pair with almost everything else.

Product Profile



1. USB-C output port with data and power

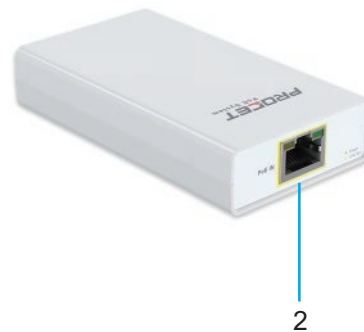

2. PoE: Data&Power input port

Product Working Diagram

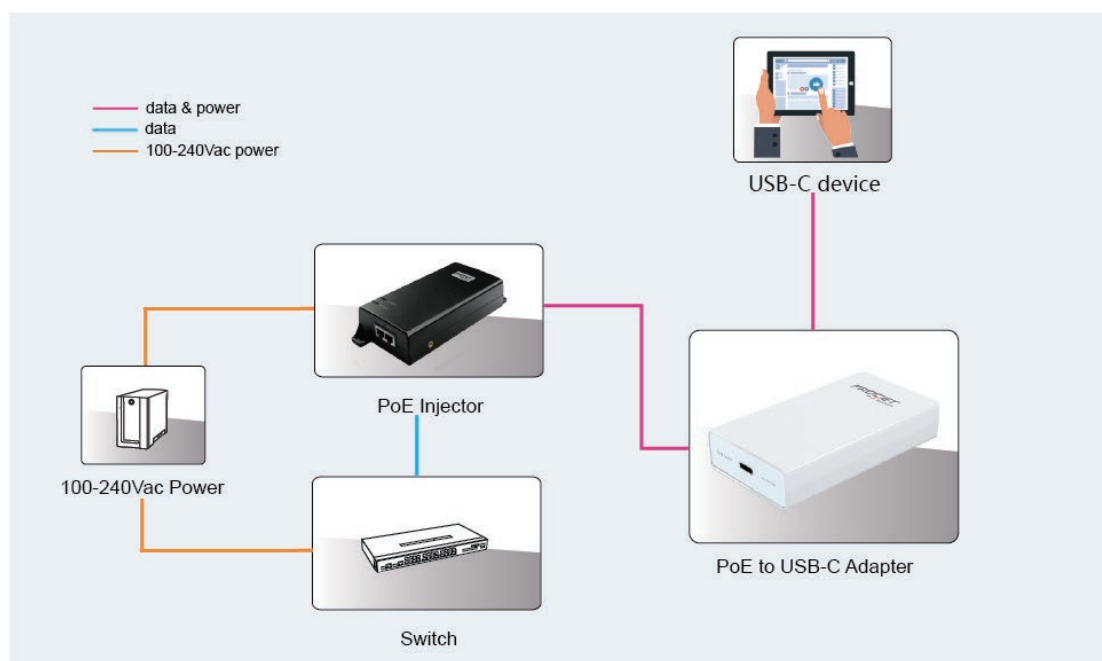

Specification

Standard

- IEEE802.3 10Base-T Ethernet
- IEEE802.3u 100Base-Tx Fast Ethernet
- Support PoE injector with IEEE802.3bt
- RoHS Compliance
- WEEE Compliance

Input & Output

- Input :44-57Vdc IEEE802.3bt
- Input Power Pins: 4/5(+), 7/8(-) and 3/6(+),1/2(-)
or 4/5(+), 7/8(-) and 3/6(-),1/2(+)
- Output: 5V/3A, 9V/3A, 12V/3A, 15V/3A, 20V/3A
- Data Speed: 10/100 Mbps

Working Environment

- Operating Temperature: 0℃ to 40℃
- Operating Humidity: 20% to 80%, non-condensation
- Storage Temperature: -20℃ to 70℃
- Storage Humidity: 10% to 90%, non-condensation
- Operating Altitude: up to 2000 meters

Mechanical Characteristics

- Case: Plastic
- Color: white
- Mounting: Desktop
- IP Rated: IP40
- Size: 100.4mm X 60mm X 22mm
- Weight: 129g
- Connectors: RJ45 Female*1
USB-C Female*1

Safety Approvals

- CE
- FCC

EMI

- FCC CFR47 Part 15, EN55032, EN55035

EMS

- IEC61000-4-2(ESD) Air discharge: 8kV,
Contact discharge: 4kV, Performance B
- IEC61000-4-3(RS) 80~1000MHz,3V/m,80%AM(1kHz),
Performance A
- IEC61000-4-4(EFT) AC Power line: 1kV, Performance B
DC Power line:0.5kV,Performance B
Signal line:0.5kV, Performance B

Immunity

- IEC60068-2-6(Vibration)
- IEC60068-2-27(Impact)
- IEC60068-2-32(Free Fall)

LED Indicator

- RJ45 Port Power Supply LED Indicator (Yellow)
Light On:Normal power supply
Light Off:Abnormal power supply
- Type-C Port Data Transmission LED Indicator (Green)
Light On:Normal connection
Blinking:Data transfer
Light Off:Abnormal connection

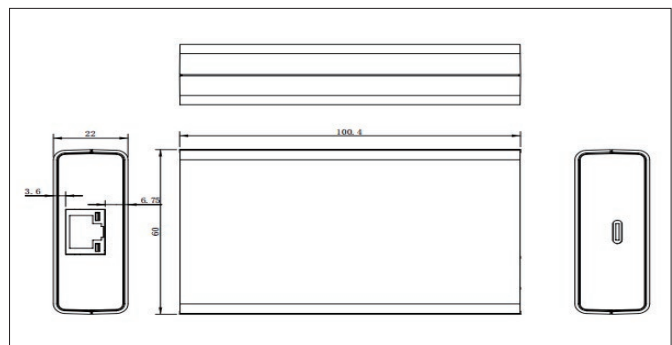

Order Info. PT-PTC-D-BT

5-20Vdc/60W(max)/PoE to USB-C

Packing.

PT-PTC-D-BT
USB-C to USB-C cable(Can deliver power and data) *0.5 meters
Manual x 1

This document belongs to PROCET company. It is not allowed to reproduce and modify without the original author's permission. It is PROCET's policy to improve its products as new technology, components, software, and firmware at any time. PROCET, therefore, reserves the right to change specifications without prior notice. (2024.09)