



PT-PSE106GBR-S

SFP 802.3bt PoE Injector

Product Overview

PT-PSE106GBR-S is a single port PoE midspan Injector with 4 Pair PoE up to 90 watts of power at 55VDC at 1.64A with 6KV (10/700us) surge protection. It supports 10/100/1000Mbps of data speed, It works for 90W PoE PDs, such as wireless APs, base stations, high power cameras, door locks, displays, POS, information kiosks and other high power Ethernet terminals. It complies to IEEE802.3bt and backward compatible with IEEE802.3af/at standard.

PT-PSE106GBR-S is designed for indoor use. It works with wide input voltage of 100-240Vac.

It has detection chip inside, which will detect and classify PD before powering it. It will not apply power until a standard-compliant PD is detected. The effective distance is 100 meters over Cat5e/Cat6 cables.



Product Profile

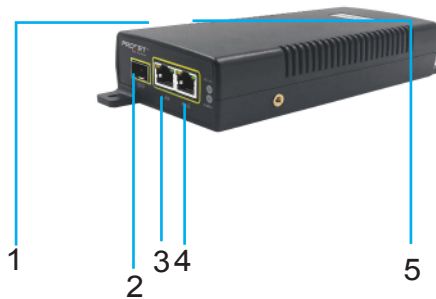

- 1. PoE Load Indicator
- 2. SFP Port: Data Input Port
- 3. LAN: Data Input Port



- 4. PoE: Data & Power Output Port
- 5. Power Indicator
- 6. Earth
- 7. AC Power Input

Product Working Diagram

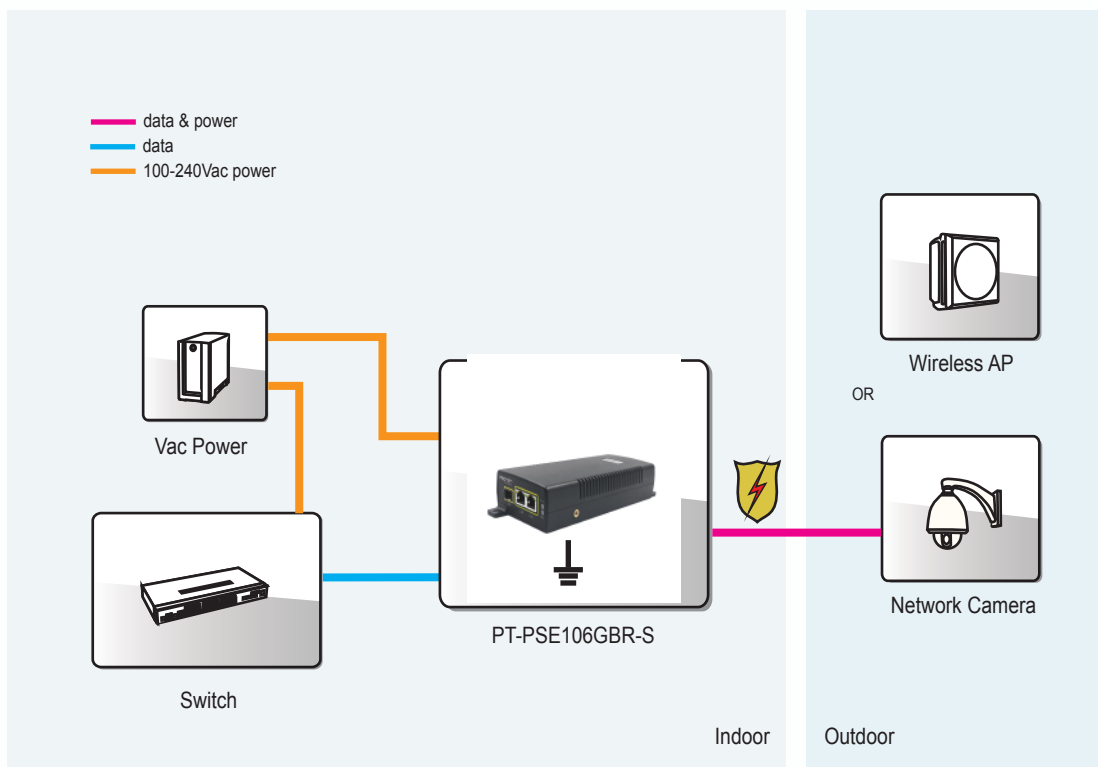

Specification

Standard

- IEEE802.3 10Base-T Ethernet
- IEEE802.3u 100Base-Tx Fast Ethernet
- IEEE802.3ab 1000Base-T Gigabit Ethernet
- Full compliant with IEEE802.3af/at/bt
- RoHS Compliance
- WEEE Compliance

Input & Output

- Input :100-240Vac 2.0A 50/60Hz
- Output: 55Vdc 1640mA
- Power Pins: 4/5(+), 7/8(-) and 3/6(+),1/2(-)
- Data Speed: 10/100/1000Mbps

Working Environment

- Operating Temperature: -5℃ to 40℃
- Operating Humidity: 5% to 85%, non-condensation
- Storage Temperature: -20℃ to 70℃
- Storage Humidity: 10% to 90%, non-condensation
- Operating Altitude: up to 5000meters

AC Surge Protection

- Line-Earth 1.2/50us (8/20us): 2KV
- Line-Line 1.2/50us (8/20us): 1KV

PoE Surge Protection

- Protected line: 1,2,3,4,5,6,7,8
- Common mode surge protection(10/700us): 6KV
- Differential mode surge protection (10/700us): 1.5KV

Mechanical Characteristics

- Case: Plastic
- Color: Black
- Mounting: Wall-mounted
- IP Rated: IP40
- Size: 178.71mm X 85mm X 41mm
- Weight: 500g

Safety Approvals

- CE
- FCC

EMI

- FCC CFR47 Part 15, EN55032, EN55035

EMS

- IEC61000-4-2(ESD) ± 4kV(contact), ±8kV(air)
- IEC61000-4-3(RS) 10V/m(80MHz~2GHz)
- IEC61000-4-4(EFT) Power Port: ±2kV; Data Port:±1kV
- IEC61000-4-5(Surge) Power Port:±1kV/DM, ±2kV/CM
- IEC61000-4-6(CS) 10V(150kHz~80MHz)

Immunity

- IEC60068-2-6(Vibration)
- IEC60068-2-27(Impact)
- IEC60068-2-32(Free Fall)

LED Indicator

- Power Indicator : Green
- PoE Load Indicator : Green

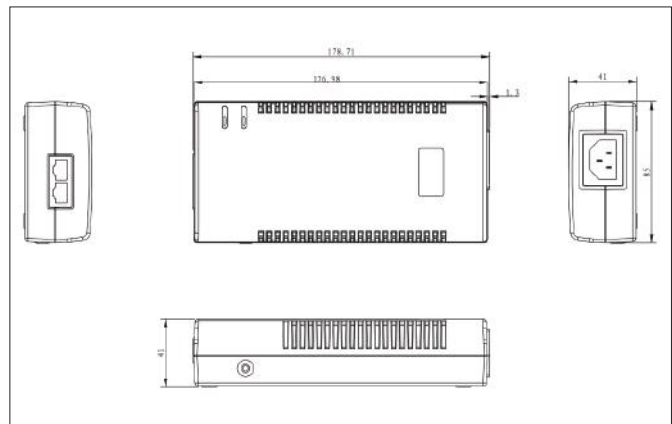

Order Info. PT-PSE106GBR-S

55Vdc/1.64A/10G/(4,5+,7,8-) and (3,6+,1,2-)/Surge Protection/Active

Packing

PT-PSE106GBR-S
Power Cord x 1 (Optional)
Manual x 1