



PT-PIS4PS-AC

AC Input 4 Port Fiber PoE Switch

Product Overview

PT-PIS4PS-AC is a 4-port, industrial-scale with fiber port PoE switch, which including 1 SFP fiber slot at 1000BASE-X SFP Interfaces, 1 AC input port and 4 PoE ports, provides 60W(total) power for remote PDs over 2 pairs output at 10/100/1000Mbps of data speed. Each PoE port is compliant with IEEE802.3at standard and backward compatible with 802.3af. Such as power for wireless access points, network cameras, VoIP Phones, Base station and other power Ethernet terminals.

PT-PIS4PS-AC is designed for indoor use but can work outdoor by covered with waterproof case. It works with input voltage of 90-263Vac and operates under -40 C to 65 C. It has detection chip inside, which will detect and classify PD before powering it. It will not apply power until a standard-compliant PD is detected. The effective distance is 100 meters over Cat5e/Cat6 cables. This model equipped standard DIN rail mounting bracket, which can easily jam into the guide rail.

Product Profile

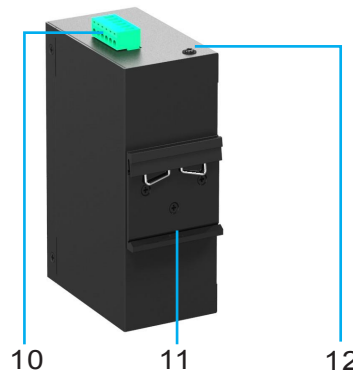
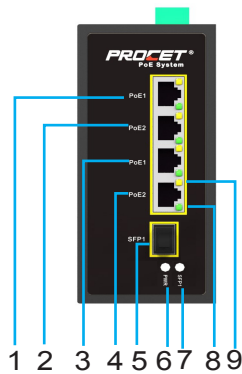

- | | | |
|----------------------------------|--------------------------------|----------------------------------|
| 1. PoE1: Data&Power output port1 | 5. SFP1: Fiber Data input port | 9. PoE4 Data Switching indicator |
| 2. PoE2: Data&Power output port2 | 6. AC Power input indicator | 10. AC Power input port |
| 3. PoE3: Data&Power output port3 | 7. SFP1 Data input indicator | 11. DIN rail mounting bracket |
| 4. PoE4: Data&Power output port4 | 8. PoE4 Load indicator | 12. Earth |

Product Working Diagram

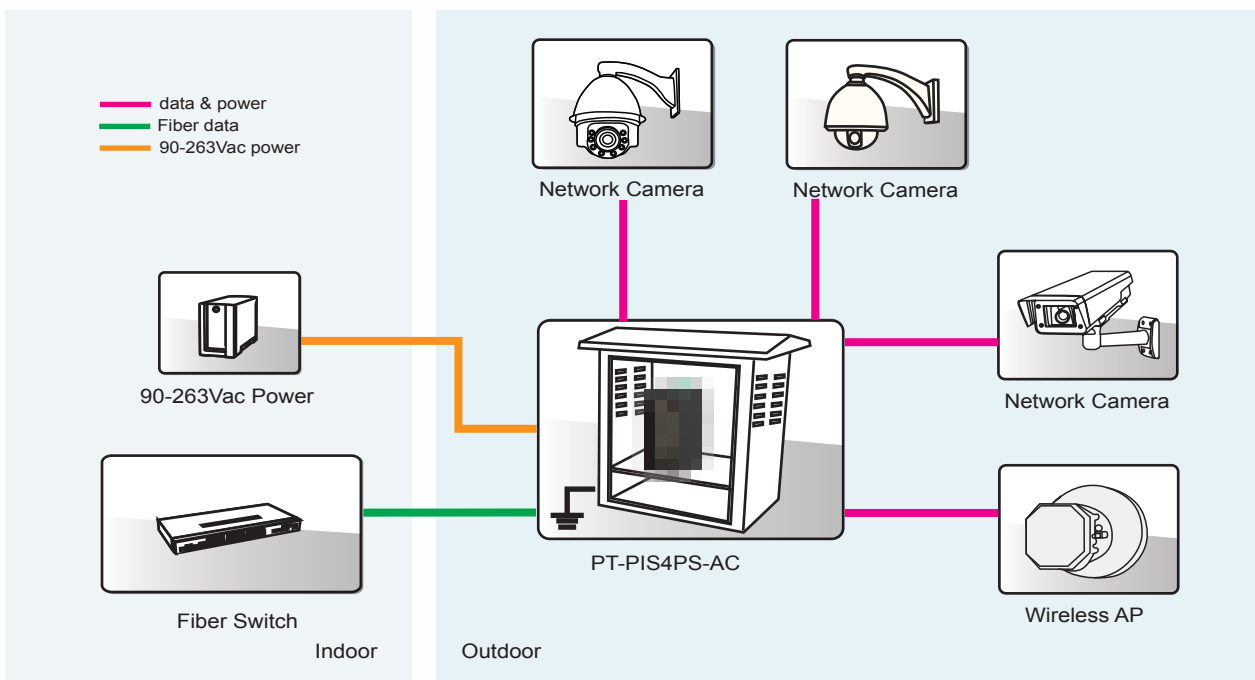

Specification

Standard

- IEEE802.3 10Base-T Ethernet
- IEEE802.3u 100Base-Tx Fast Ethernet
- IEEE802.3ab 1000Base-T Gigabit Ethernet
- Full compliant with IEEE802.3af/at
- RoHS Compliance
- WEEE Compliance

Input & Output

- Input : 90-263Vac
- Output: 15.4W(max) per port, 60W total
- Power Pins: 3/6(+), 1/2(-)
- Data Speed: 10/100/1000BASE-T RJ45 Interfaces
1000BASE-X SFP Interfaces

Working Environment

- Operating Temperature: -40℃ to 65℃
- Operating Humidity: 20% to 80%, non-condensation
- Storage Temperature: -40℃ to 85℃
- Storage Humidity: 10% to 90%, non-condensation
- Operating Altitude: up to 5000meters

Mechanical Characteristics

- Case: Metal
- Color: Black
- Mounting: DIN-rail
- IP Rated: IP40
- Size: 144.5mm X 104.2mm X 60mm
- Weight: 819g

LED Indicator

- Power Indicator : Green
- PoE Load Indicator : Green
- PoE Data Switching Indicator: Green
- SFP Data Input Indicator: Green

EMI

- FCC CFR47 Part 15, EN55032, EN55035

EMS

- IEC61000-4-2(ESD) ± 6 kV(contact), ± 8 kV(air)
- IEC61000-4-3(RS) 10V/m(80MHz~2GHz)
- IEC61000-4-4(EFT) Power Port: ± 2 kV; Data Port: ± 1 kV
- IEC61000-4-5(Surge) Power Port: ± 1 kV/DM, ± 2 kV/CM
- IEC61000-4-6(CS) 10V(150kHz~80MHz)

Immunity

- IEC60068-2-6(Vibration)
- IEC60068-2-27(Impact)
- IEC60068-2-32(Free Fall)

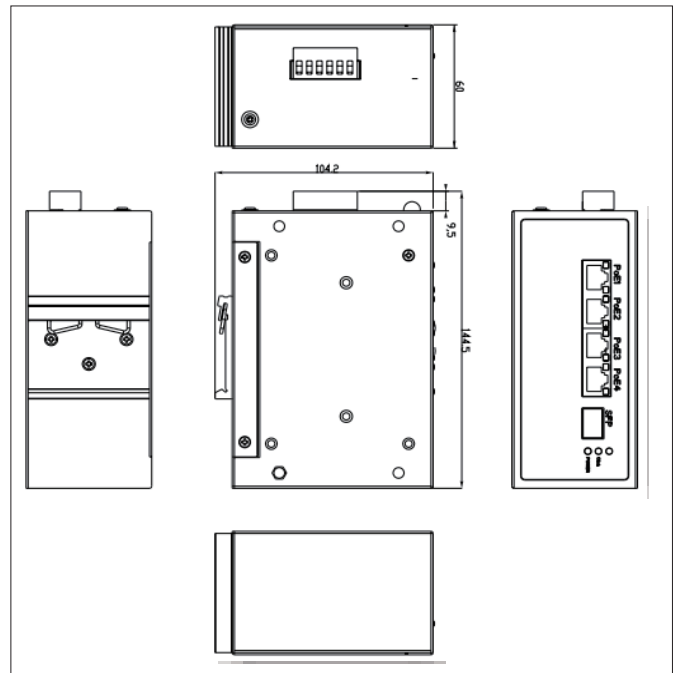

Order Info. PT-PIS4PS-AC

15.4W Per Port, 60W total/4 port/1000Mbps/(3/6+,1/2-)Wide Temperature/Active

Packing PT-PIS4PS-AC
Manual x 1