



PT-PSE109GBRO-A-S

Industrial 95W SFP PoE Injector

Product Overview

PT-PSE109GBRO-A-S is a single-port industrial PoE Injector with SFP fiber connection port. It is specially designed for complex backhaul and networking applications. It provides 55Vdc, 95W power for remote PDs over full 4pairs output with lightning surge protection. It supports both 10/100Base-T and Gigabit device. The PoE output port support IEEE802.3af/at, PoE++ standard making it compatible with PoE, PoE+, PoE++ devices, such as wireless APs, IP cameras, VoIP phones, base stations, door locks, displays, POS, information kiosks and other high-power Ethernet backhaul devices.

PT-PSE109GBRO-A-S is designed for indoor use but can work outdoor by covered with waterproof case. It works with 100-240Vac input and operates under -40°C to +65°C. It has detection chip inside, which will detect and classify PD before powering it. It will not provide power until a standard-compliant PD is detected. The effective distance is 100M over Cat5e/Cat6 cables. It works like a switch, data is interoperable among LAN port, PoE port and SFP port. It is easy to install with 4 mounting holes.



Product Profile

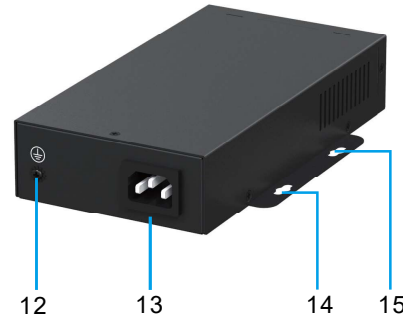
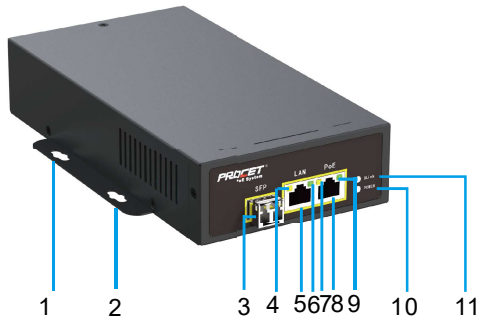

- | | | |
|-------------------------------|--------------------------------|--------------------------|
| 3. SFP: Fiber data input port | 7. PoE indicator | 11. SFP fiber indicator |
| 4. LAN data indicator | 8. PoE: Data&Power output port | 12. Earth |
| 5. LAN: Data input port | 9. PoE Load indicator | 13. AC input port |
| 6. Unused | 10. Power indicator | 1,2,14,15. mounting hole |

Product Working Diagram

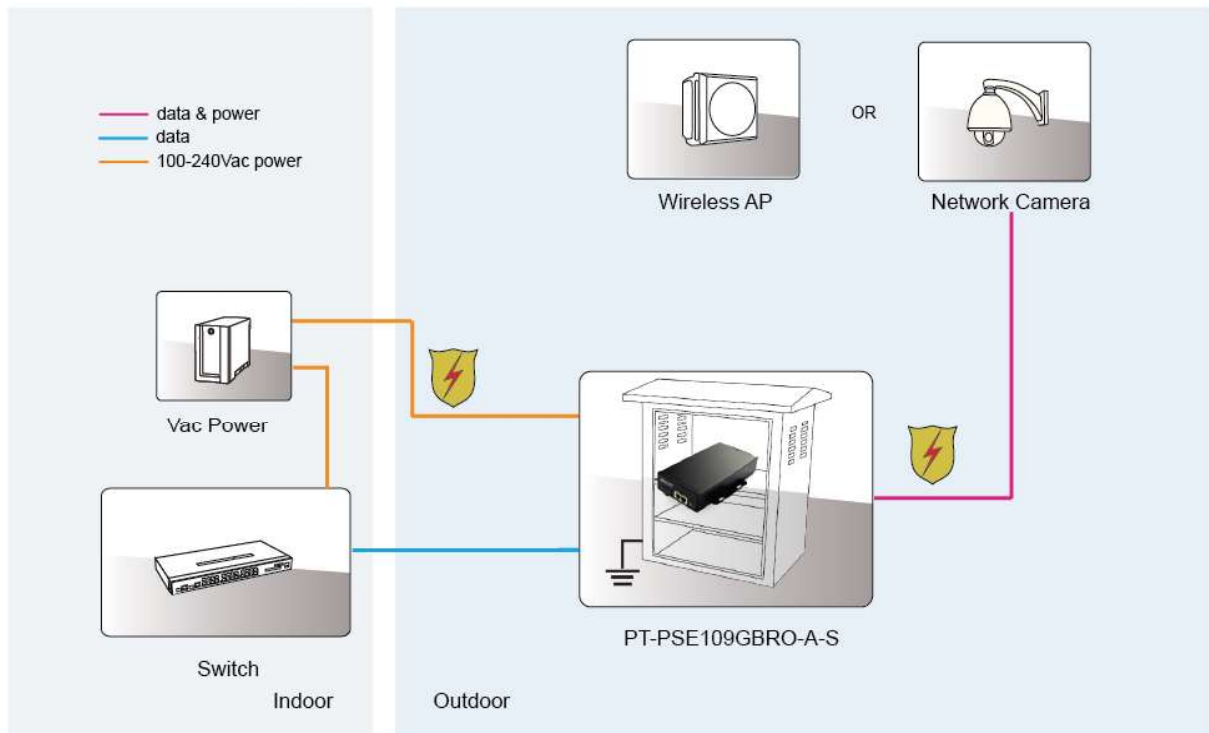

Specification

Standard

- IEEE802.3 10Base-T Ethernet
- IEEE802.3u 100Base-Tx Fast Ethernet
- IEEE802.3ab 1000Base-T Gigabit Ethernet
- Full compliant with IEEE802.3af/at, PoE++
- RoHS Compliance
- WEEE Compliance

Input & Output

- Input :100-240Vac 2.0A 50/60Hz
- Output: 55Vdc 1750mA
- Power Pins: 4/5(+), 7/8(-) and 3/6(+),1/2(-)
- Data Speed: 10/100/1000Mbps

Working Environment

- Operating Temperature: -40℃ to 65℃
- Operating Humidity: 20% to 80%, non-condensation
- Storage Temperature: -40℃ to 85℃
- Storage Humidity: 10% to 90%, non-condensation
- Operating Altitude: up to 5000meters

AC Surge Protection

- Line-Earth 1.2/50us (8/20us): 6KV
- Line-Line 1.2/50us (8/20us): 4KV

PoE Surge Protection

- Protected line: 1,2,3,4,5,6,7,8
- Common mode surge protection(10/700us): 4KV
- Differential mode surge protection (10/700us): 1.5KV

Mechanical Characteristics

- Case: Metal
- Color: Black
- Mounting: Wall-mounted
- IP Rated: IP20
- Size: 214mm X 134mm X 41mm
- Weight: 920g

Safety Approvals

- cUL/UL
- CE
- CB
- FCC
- RCM
- NOM

EMI

- FCC CFR47 Part 15, EN55024, EN55032

EMS

- IEC61000-4-2(ESD) ± 6kV(contact), ±8kV(air)
- IEC61000-4-3(RS) 10V/m(80MHz~2GHz)
- IEC61000-4-4(EFT) Power Port: ±2kV; Data Port:±1kV
- IEC61000-4-5(Surge) Power Port:±1kV/DM, ±2kV/CM
- IEC61000-4-6(CS) 10V(150kHz~80MHz)

Immunity

- IEC60068-2-6(Vibration)
- IEC60068-2-27(Impact)
- IEC60068-2-32(Free Fall)

LED Indicator

- Power indicator: Green
- Load active Indicator: Green
- SFP fiber indicator: Green
- LAN data indicator: Yellow

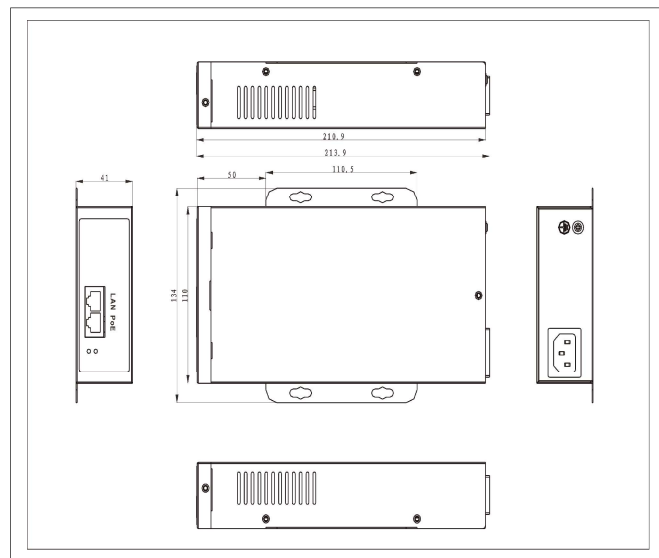

Order Info.

PT-PSE109GBRO-A-S 55Vdc/95W/1000Mbps/(4,5+,7,8-) and (3,6+,1,2-)/Surge Protection/Active

Packing

PT-PSE109GBRO-A-S x 1
Power Cord x 1 (Optional)
Operation Manual x 1

This document belongs to PROCET company. It is not allowed to reproduce and modify without the original author's permission. It is PROCET's policy to improve its products as new technology, components, software, and firmware at any time. PROCET, therefore, reserves the right to change specifications without prior notice. (2019.05)