



Wide-temperature 60W SFP PoE Injector

PT-PSE107GRO-S

Product Overview

PT-PSE107GRO-S is a single port PoE Injector with SFP fiber connection port. It provides 55Vdc, 1.1A power for remote PDs over full-4pairs output with 4KV (10/700us) surge protection. It supports both 10/100Base-T and Gigabit device. It works for 60W PoE PDs, such as wireless APs, base stations, high power cameras, door locks, displays, POS, information kiosks and other high power Ethernet terminals. It is also compatible and safe to use with any IEEE802.3af/at, PoE++ compliant terminals. It works like a switch, data is interoperable among LAN port, PoE port and SFP port.

PT-PSE107GRO-S is designed for indoor use but can work outdoor by covered with waterproof case. It works with 100-240Vac input and operates under -40 °C to +65 °C full loading. It has detection chip inside, which will detect and classify PD before powering it. It will not provide power until a standard-compliant PD is detected. The effective distance is 100 meters over Cat5e/Cat6 cables. It is specially suitable for working in complex power situations.



Product Profile

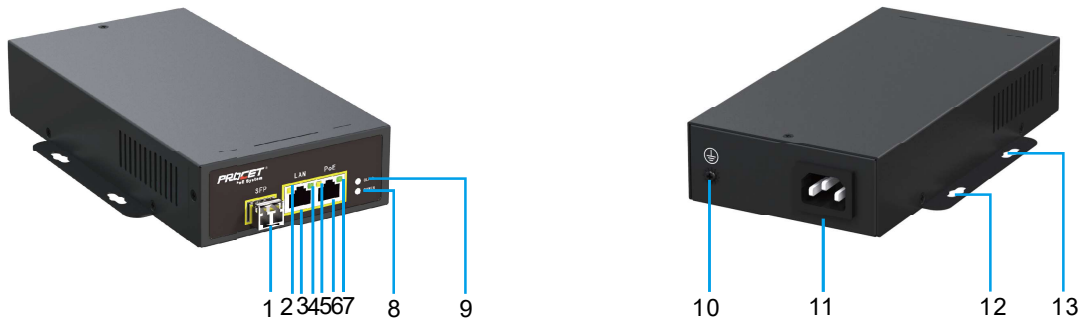

- | | | |
|-----------------------|--------------------------|------------------------|
| 1. SFP fiber port | 5. PoE indicator | 9. SFP fiber indicator |
| 2. LAN data indicator | 6. PoE port | 10. Earth |
| 3. LAN port | 7. Load active indicator | 11. AC input port |
| 4. Unused | 8. Power indicator | 12,13. mounting hole |

Product Working Diagram

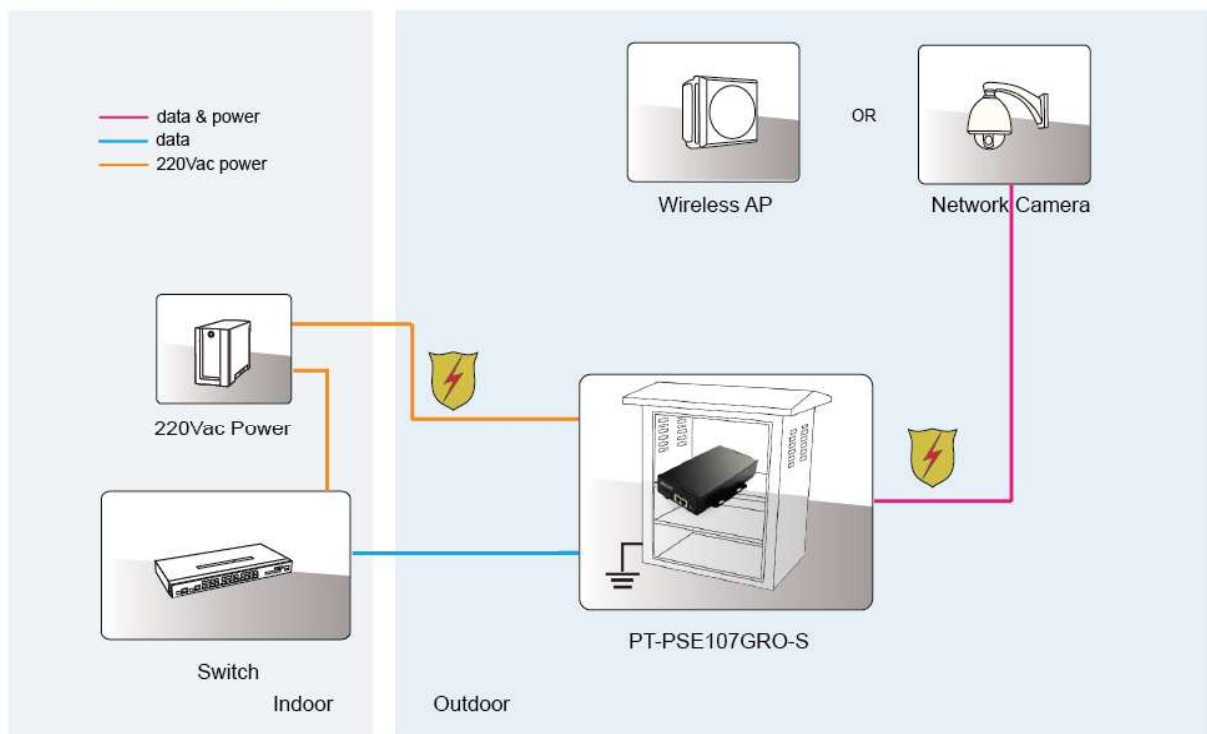

Specification

Standard

- IEEE802.3 10Base-T Ethernet
- IEEE802.3u 100Base-Tx Fast Ethernet
- IEEE802.3ab 1000Base-T Gigabit Ethernet
- Full compliant with IEEE802.3af/at, PoE++
- RoHS Compliance
- WEEE Compliance

Input & Output

- Input :100-240Vac 1.5A 50/60Hz
- Output: 55Vdc 1100mA
- Power Pins: 4/5(+), 7/8(-) and 3/6(+),1/2(-)
- Data Speed: 10/100/1000Mbps

Working Environment

- Operating Temperature: -40℃ to 65℃
- Operating Humidity: 20% to 80%, non-condensation
- Storage Temperature: -40℃ to 85℃
- Storage Humidity: 10% to 90%, non-condensation
- Operating Altitude: up to 5000meters

AC Surge Protection

- 1.0KV (5P/5N)
- L-N 1.2/50 (8/20) Tr/Th us
- 2.0KV (5P/5N)
- L-PE 1.2/50 (8/20) Tr/Th us
- N -PE

PoE Surge Protection

- Protected line: 1,2,3,4,5,6,7,8
- Common mode surge protection(10/700us): 4KV
- Differential mode surge protection (10/700us): 1.5KV

Mechanical Characteristics

- Case: Metal
- Color: Black
- Mounting: Wall-mounted
- IP Rated: IP20
- Size: 203mm X 130mm X 41mm
- Weight: 910g

Order Info.

PT-PSE107GRO-S

55Vdc/1.1A/1000M/(4,5+,7,8-) and (3,6+,1,2-)/Surge Protection/Active

Packing

PT-PSE107GRO-S x 1
Power Cord x 1 (Optional)
Operation Manual x 1

Safety Approvals

- CE
- FCC

EMI

- FCC CFR47 Part 15, EN55024, EN55032

EMS

- IEC61000-4-2(ESD) ± 6kV(contact), ±8kV(air)
- IEC61000-4-3(RS) 10V/m(80MHz~2GHz)
- IEC61000-4-4(EFT) Power Port: ±2kV; Data Port:±1kV
- IEC61000-4-5(Surge) Power Port:±1kV/DM, ±2kV/CM
- IEC61000-4-6(CS) 10V(150kHz~80MHz)

Immunity

- IEC60068-2-6(Vibration)
- IEC60068-2-27(Impact)
- IEC60068-2-32(Free Fall)

LED Indicator

- Power indicator: Green
- Load active Indicator: Green
- SFP fiber indicator: Green
- LAN data indicator: Yellow

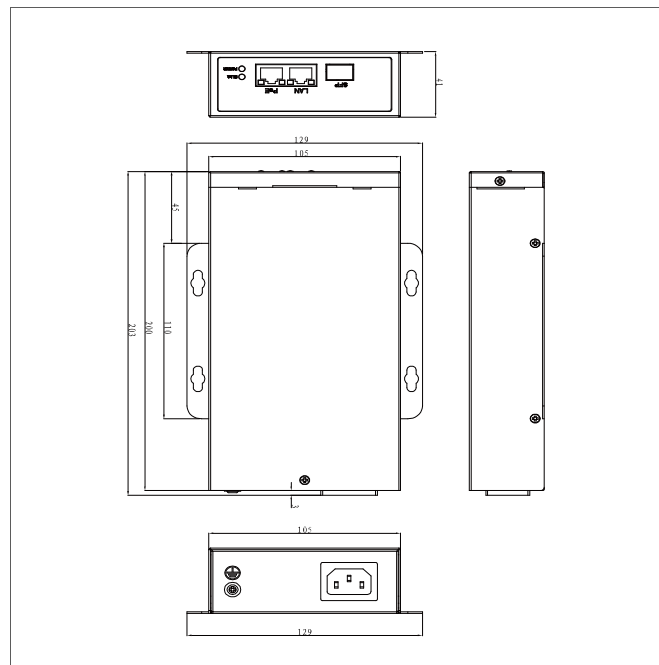

This document belongs to PROCET company. It is not allowed to reproduce and modify without the original author's permission. It is PROCET's policy to improve its products as new technology, components, software, and firmware at any time. PROCET, therefore, reserves the right to change specifications without prior notice. (2018.06)