



PT-PSE106GRO

Wide Temperature 1-Port PoE Injector

Product Overview

PT-PSE106GRO is a single port PoE Injector with wide temperature. It provides 55Vdc, 0.55A power for remote PDs over 2-pairs output with 6KV (10/700us) surge protection. It supports both 10/100Base-T and Gigabit device. It works for 30W PoE PDs, such as wireless APs, base stations, high power cameras, door locks, displays, POS, information kiosks and other high power Ethernet terminals. It is also compatible and safe to use with any IEEE802.3 af/at compliant terminals.

PT-PSE106GRO is designed for indoor use but can work outdoor by covered with waterproof case. It works with input voltage of 100-240Vac and operates under -40 °C to 65 °C. It has detection chip inside, which will detect and classify PD before powering it. It will not apply power until a standard-compliant PD is detected. The effective distance is 100 meters over Cat5e/Cat6 cables.



Product Profile



1 2

- 1. LAN: Data Input Port
- 2. PoE: Data & Power Output Port
- 3. AC Power Input



3

- 4. Power Indicator
- 5. PoE Load Indicator
- 6. Earth



4 5 7

- 7,8. Mounting Hole

6

8

Product Working Diagram

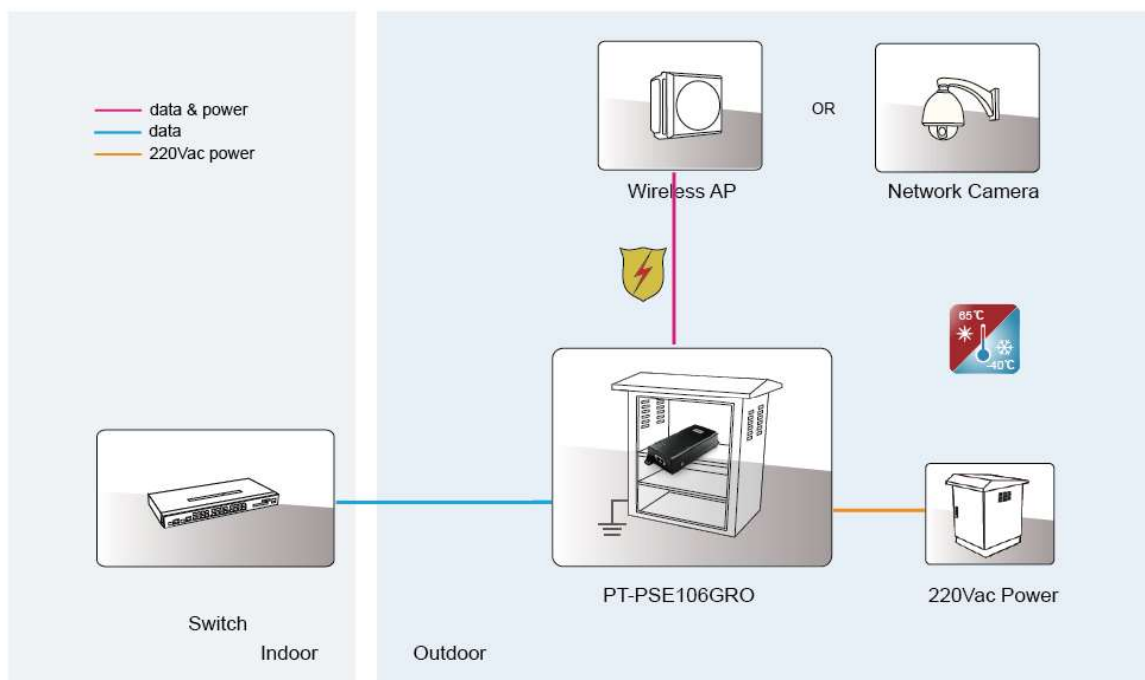

Specification

Standard

- IEEE802.3 10Base-T Ethernet
- IEEE802.3u 100Base-Tx Fast Ethernet
- IEEE802.3ab 1000Base-T Gigabit Ethernet
- Full compliant with IEEE802.3af/at, PoE++
- RoHS Compliance
- WEEE Compliance

Input & Output

- Input :100-240Vac 1.0A 50/60Hz
- Output: 55Vdc 550mA
- Power Pins: 4/5(+), 7/8(-)
- Data Speed: 10/100/1000Mbps

Working Environment

- Operating Temperature: -40℃ to 65℃
- Operating Humidity: 20% to 80%, non-condensation
- Storage Temperature: -40℃ to 85℃
- Storage Humidity: 10% to 90%, non-condensation
- Operating Altitude: up to 5000meters

AC Surge Protection

- 1.0KV (5P/5N)
- L-N 1.2/50 (8/20) Tr/Th us
- 2.0KV (5P/5N)
- L-PE 1.2/50 (8/20) Tr/Th us
- N -PE

PoE Surge Protection

- Protected line: 1,2,3,4,5,6,7,8
- Common mode surge protection(10/700us): 6KV
- Differential mode surge protection (10/700us): 1.5KV

Mechanical Characteristics

- Case: Plastic
- Color: Black
- Mounting: Wall-mounted
- IP Rated: IP40
- Size: 193mm X 85mm X 41mm
- Weight: 425g

Safety Approvals

- CE
- FCC

EMI

- FCC CFR47 Part 15, EN55024, EN55032

EMS

- IEC61000-4-2(ESD) ± 6kV(contact), ±8kV(air)
- IEC61000-4-3(RS) 10V/m(80MHz~2GHz)
- IEC61000-4-4(EFT) Power Port: ±2kV; Data Port:±1kV
- IEC61000-4-5(Surge) Power Port:±1kV/DM, ±2kV/CM
- IEC61000-4-6(CS) 10V(150kHz~80MHz)

Immunity

- IEC60068-2-6(Vibration)
- IEC60068-2-27(Impact)
- IEC60068-2-32(Free Fall)

LED Indicator

- Power Indicator : Green
- PoE Load Indicator : Green

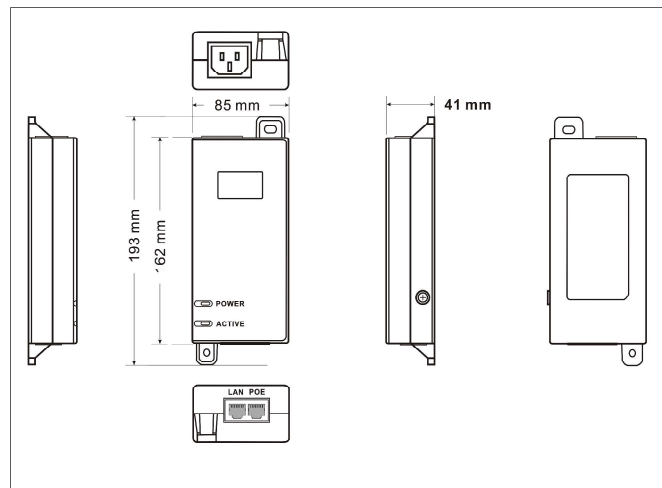

Order Info. PT-PSE106GRO

55Vdc/0.55A/1000Mbps/(4,5+,7,8-)/Surge Protection/Active

Packing

PT-PSE106GRO
Power Cord x 1 (Optional)
Manual x 1



This document belongs to PROCET company. It is not allowed to reproduce and modify without the original author's permission. It is PROCET's policy to improve its products as new technology, components, software, and firmware at any time. PROCET, therefore, reserves the right to change specifications without prior notice. (2018.05)