



**PT-PEX-01G-OT**

## Outdoor Single-Port PoE Extender

### Product Overview

PT-PEX-01G-OT is a single-port PoE extender with sealing gasket inside and Aluminum alloy shell which are waterproof. It delivers 55Vdc(typical), 1.1A power from PoE Injector/switch to remote PDs over full 4 pairs with 6KV (10/700us) surge protection. It supports 10/100/1000Mbps of data speed. It works with 60W(Max) PoE PDs, such as wireless APs, base stations, network cameras and other high power Ethernet terminals. It supports terminal equipments with IEEE802.3af/at,PoE ++ standard.

PT-PEX-01G-OT is designed for outdoor use. It works with input voltage of 44-57Vdc from PoE injector/switch and operates under -40 °C to +65 °C. On the input side, it connects to PoE injector or PoE switch, on the output side, it connects to PDs. The total effective distance from PoE injector to PD is 200 meters by CAT5e/CAT6 cables without local power. It can work longer to 500 meters with adding 4 PoE extenders. It is easy to install with 2 mounting holes and is specially suitable for working in complex power situations.



### Product Profile

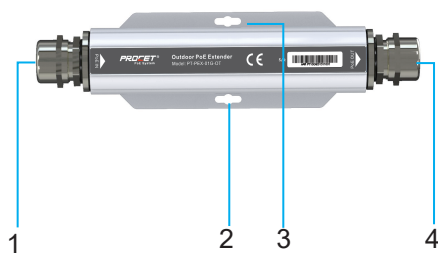

- 1. PoE Input Port
- 2.3. Mounting Hole

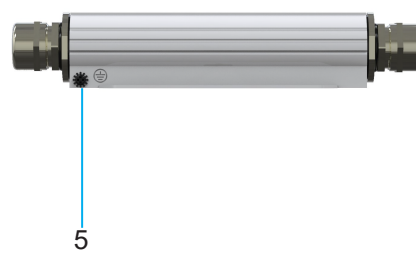

- 4. PoE Output Port
- 5. Earth

### Product Working Diagram

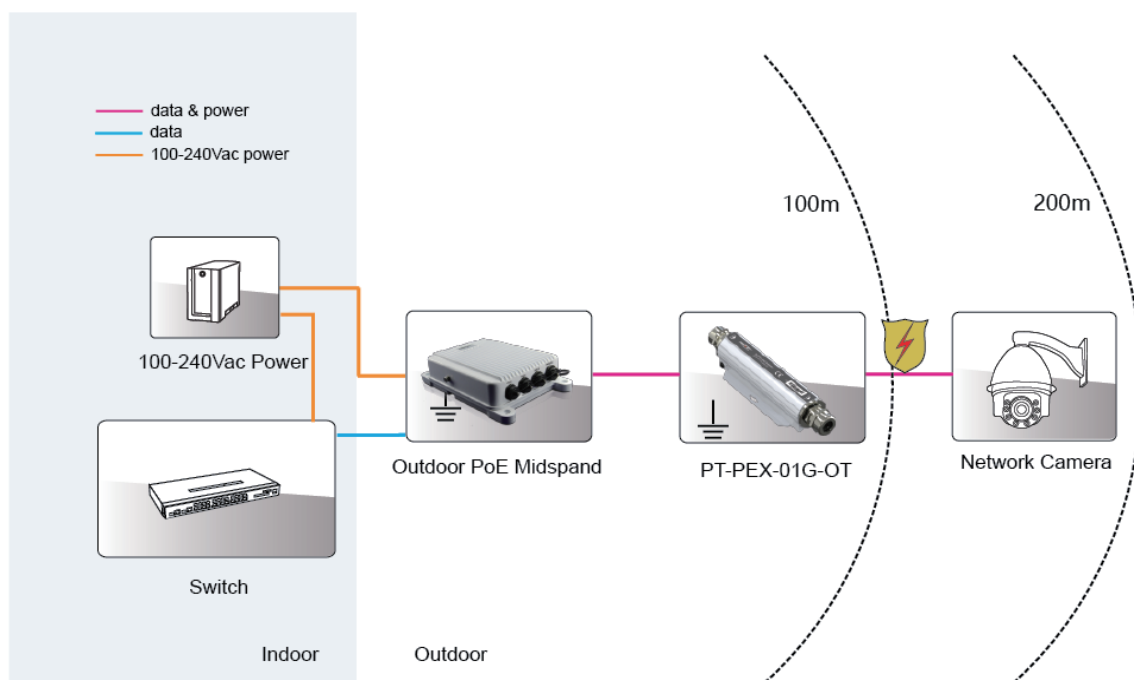

## Specification

### Standard

- IEEE802.3 10Base-T Ethernet
- IEEE802.3u 100Base-Tx Fast Ethernet
- IEEE802.3ab 1000Base-T Gigabit Ethernet
- Support equipments with IEEE802.3af/at,PoE++
- RoHS Compliance
- WEEE Compliance

### Input & Output

- Operating Voltage :44-57Vdc(Max 60Vdc)
- Maximum Operating DC Current :1.1A for 4 pairs,  
maximum 60W
- Power Pins: 4/5(+), 7/8(-) and 3/6(+),1/2(-)
- Data Speed: 10/100/1000Mbps

### Working Environment

- Operating Temperature: -40℃ to 65℃
- Operating Humidity: 20% to 80%, non-condensation
- Storage Temperature: -40℃ to 85℃
- Storage Humidity: 10% to 95%, non-condensation
- Operating Altitude: up to 5000meters

### PoE Surge Protection

- Protected Line: 1,2,3,4,5,6,7,8
- Common Mode Protection Level(10/700us): 6KV
- Differential Mode Protection Level(10/700us): 1.5KV
- Clamping Voltage(Line to GND): 300V
- Clamping Voltage(Line to Line): 10V
- Insertion Loss @10MHz/100MHz: -1db
- Return Loss @10MHz/100MHz: -20db
- Response Time: 5ns

### Mechanical Characteristics

- Case: Aluminium alloy
- Color: White
- Mounting: Wall-mounted
- IP Rated: IP67
- Size: 209mm X 53mm X 37.5mm
- Weight: 410g

### EMI

- FCC CFR47 Part 15, EN55024, EN55032

### EMS

- IEC61000-4-2(ESD)  $\pm 6\text{kV}$ (contact),  $\pm 8\text{kV}$ (air)
- IEC61000-4-3(RS) 10V/m(80MHz~2GHz)
- IEC61000-4-4(EFT) Power Port:  $\pm 2\text{kV}$ ; Data Port: $\pm 1\text{kV}$
- IEC61000-4-5(Surge) Power Port: $\pm 1\text{kV/DM}$ ,  $\pm 2\text{kV/CM}$
- IEC61000-4-6(CS) 10V(150kHz~80MHz)

### Immunity

- IEC60068-2-6(Vibration)
- IEC60068-2-27(Impact)
- IEC60068-2-32(Free Fall)

### Physical interface

- PoE input: RJ45(with waterproof jacket)
- PoE output: RJ45(with waterproof jacket)

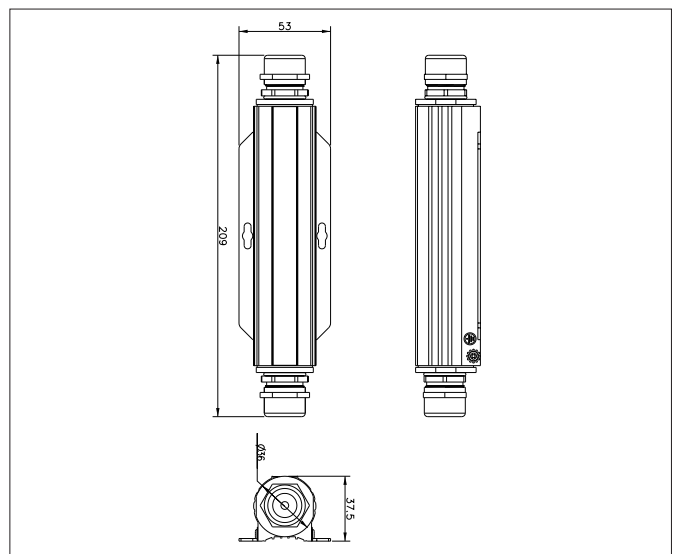

**Order Info.** PT-PEX-01G-OT

44-57Vdc(Max 60Vdc)/60W/1000Mbps/6KV Surge Protection/IP67/Outdoor use

### Packing

PT-PEX-01G-OT  
Ground lug Wire: 16AWG  
Manual x 1

### Attention

There will be power loss after adding two or more extenders, but the output power can be up to 60W for your PD with one extender.



This document belongs to PROCET company. It is not allowed to reproduce and modify without the original author's permission. It is PROCET's policy to improve its products as new technology, components, software, and firmware at any time. PROCET, therefore, reserves the right to change specifications without prior notice. (2018.06)