



## Wide-temperature 75W Gigabit PoE Injector

**PT-PSE107GHOR**

### Product Overview

PT-PSE107GHOR is a single port PoE Injector with wide temperature. It provides 55Vdc, 1.36A power for remote PDs over full 4 pairs output with 6KV (10/700us) surge protection. It supports 10/100/1000Mbps of data speed. It works for 75W PoE PDs, such as wireless APs, base stations, high power cameras, door locks, displays, POS, information kiosks and other high power Ethernet terminals. It is also compatible and safe to use with any IEEE 802.3af/at, PoE++ compliant terminals.

PT-PSE107GHOR is designed for indoor use but can work outdoor by covered with waterproof case. It works with 100-240Vac input and operates under -40 °C to +65 °C full loading. It has detection chip inside, which will detect and classify PD before powering it. It will not provide power until a standard-compliant PD is detected. The effective distance is 100 meters over Cat5e/Cat6 cables. It is specially suitable for working in complex power situations.



### Product Profile

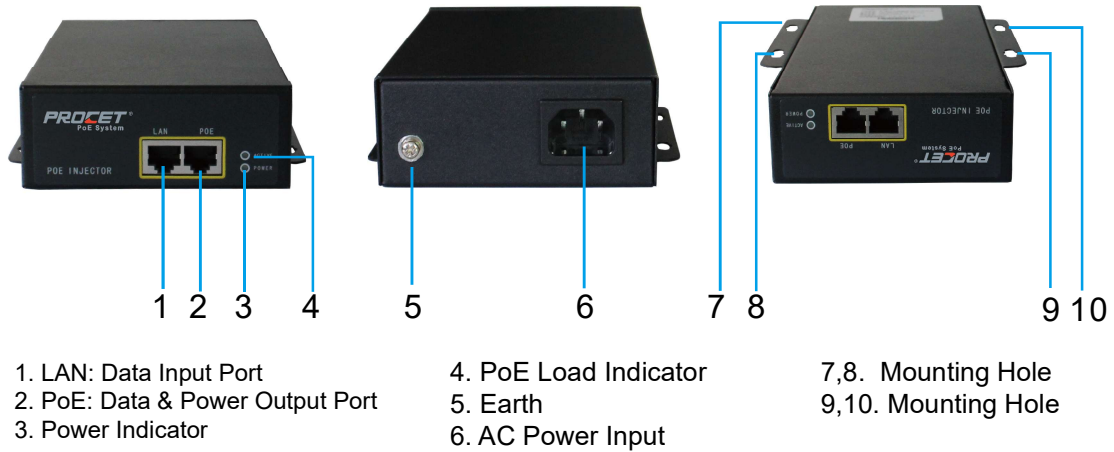

### Product Working Diagram

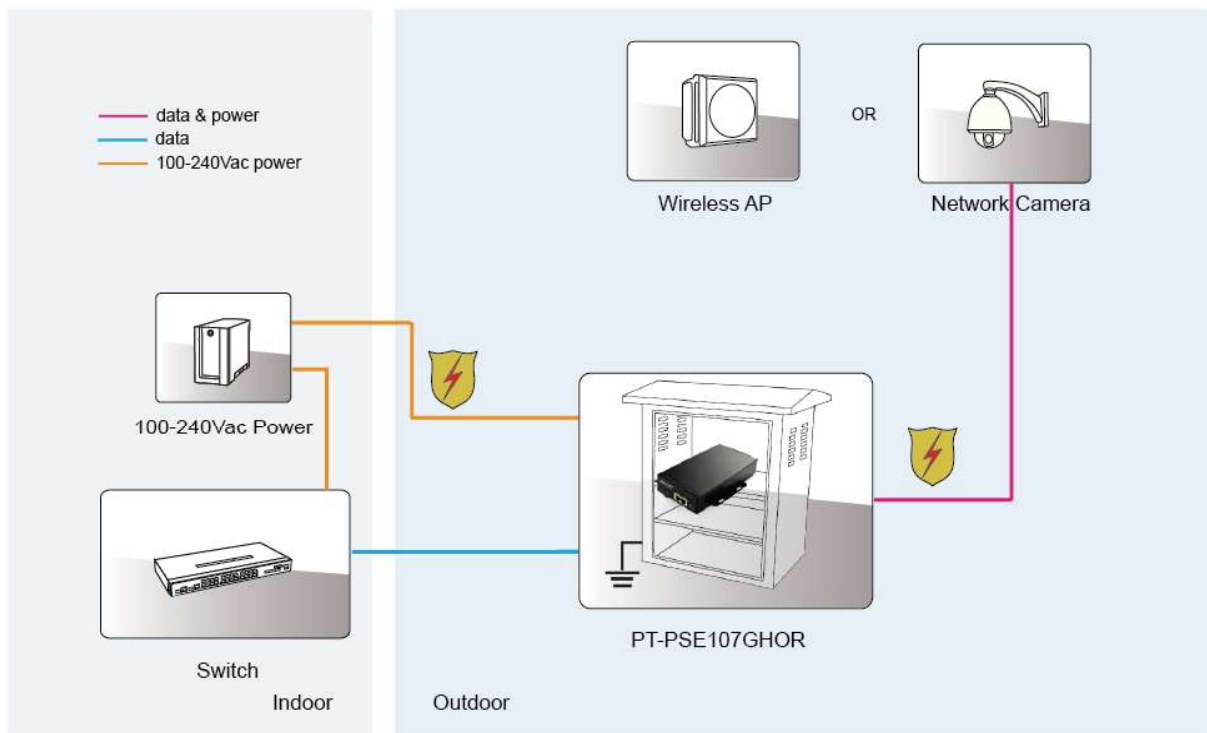

## Specification

### Standard

- IEEE802.3 10Base-T Ethernet
- IEEE802.3u 100Base-Tx Fast Ethernet
- IEEE802.3ab 1000Base-T Gigabit Ethernet
- Full compliant with IEEE802.3af/at, PoE++
- RoHS Compliance
- WEEE Compliance

### Input & Output

- Input :100-240Vac 1.5A 50/60Hz
- Output: 55Vdc 1360mA
- Power Pins: 4/5(+), 7/8(-) and 3/6(+),1/2(-)
- Data Speed: 10/100/1000Mbps

### Working Environment

- Operating Temperature: -40℃ to 65℃
- Operating Humidity: 20% to 80%, non-condensation
- Storage Temperature: -40℃ to 85℃
- Storage Humidity: 10% to 90%, non-condensation
- Operating Altitude: up to 5000meters

### AC Surge Protection

- Line-Earth 1.2/50us (8/20us): 2KV
- Line-Line 1.2/50us (8/20us): 1KV

### PoE Surge Protection

- Protected line: 1,2,3,4,5,6,7,8
- Common mode surge protection(10/700us): 6KV
- Differential mode surge protection (10/700us): 1.5KV

### Mechanical Characteristics

- Case: Metal
- Color: Black
- Mounting: Wall-mounted
- IP Rated: IP20
- Size: 204mm X 130mm X 41mm
- Weight: 737g

## Safety Approvals

- CE
- FCC

## EMI

- FCC CFR47 Part 15, EN55024, EN55032

## EMS

- IEC61000-4-2(ESD) ± 6kV(contact), ±8kV(air)
- IEC61000-4-3(RS) 10V/m(80MHz~2GHz)
- IEC61000-4-4(EFT) Power Port: ±2kV; Data Port:±1kV
- IEC61000-4-5(Surge) Power Port:±1kV/DM, ±2kV/CM
- IEC61000-4-6(CS) 10V(150kHz~80MHz)

## Immunity

- IEC60068-2-6(Vibration)
- IEC60068-2-27(Impact)
- IEC60068-2-32(Free Fall)

## LED Indicator

- Power Indicator: Green
- PoE Load Indicator: Green

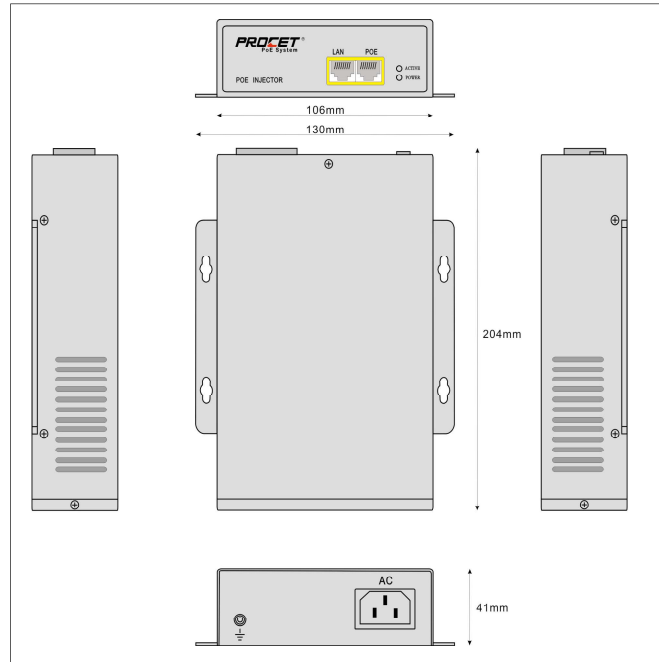

## Order Info.

PT-PSE107GHOR

55Vdc/1.36A/1000Mbps/(4,5+,7,8-) and (3,6+,1,2-)/Surge Protection/Active

## Packing

PT-PSE107GHOR x 1  
Power Cord x 1 (Optional)  
Operation Manual x 1



This document belongs to PROCET company. It is not allowed to reproduce and modify without the original author's permission. It is PROCET's policy to improve its products as new technology, components, software, and firmware at any time. PROCET, therefore, reserves the right to change specifications without prior notice. (2018.06)