



Wide-temperature 95W Gigabit PoE Injector

PT-PSE109GBRO

Product Overview

PT-PSE109GBRO, it is a single-port PoE Injector with wide-temperature. It provides 55Vdc, 1.75A power for remote PDs over full 4pairs with 6KV (10/700us) surge protection. It supports both 10/100Base-T and Gigabit device. It works for 95W PoE PDs, such as wireless APs, base stations, high power cameras, door locks, displays, POS, information kiosks and other high power Ethernet terminals. It is also compatible and safe to use with any IEEE802.3af/at, PoE++ compliant terminals.

PT-PSE109GBRO is designed for indoor use but can work outdoor by covered with waterproof case. It works with 100-240Vac input and operates under -40℃ to +65℃. It has detection chip inside, which will detect and classify PD before powering it. It will not provide power until a standard compliant PD is detected. The effective distance is 100m over Cat5e/Cat6 cables. It is specially suitable for working in complex power situations.



Product Profile

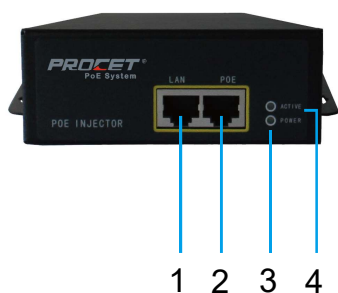

1. LAN: Data Input Port
2. PoE: Data & Power Output Port
3. Power Indicator

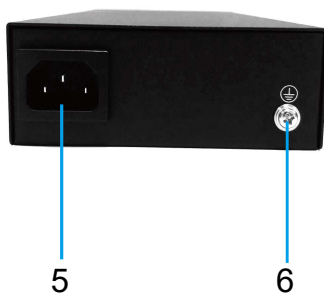

4. PoE Load Indicator
5. AC Power Input
6. Earth



- 7,8. Mounting Hole

Product Working Diagram

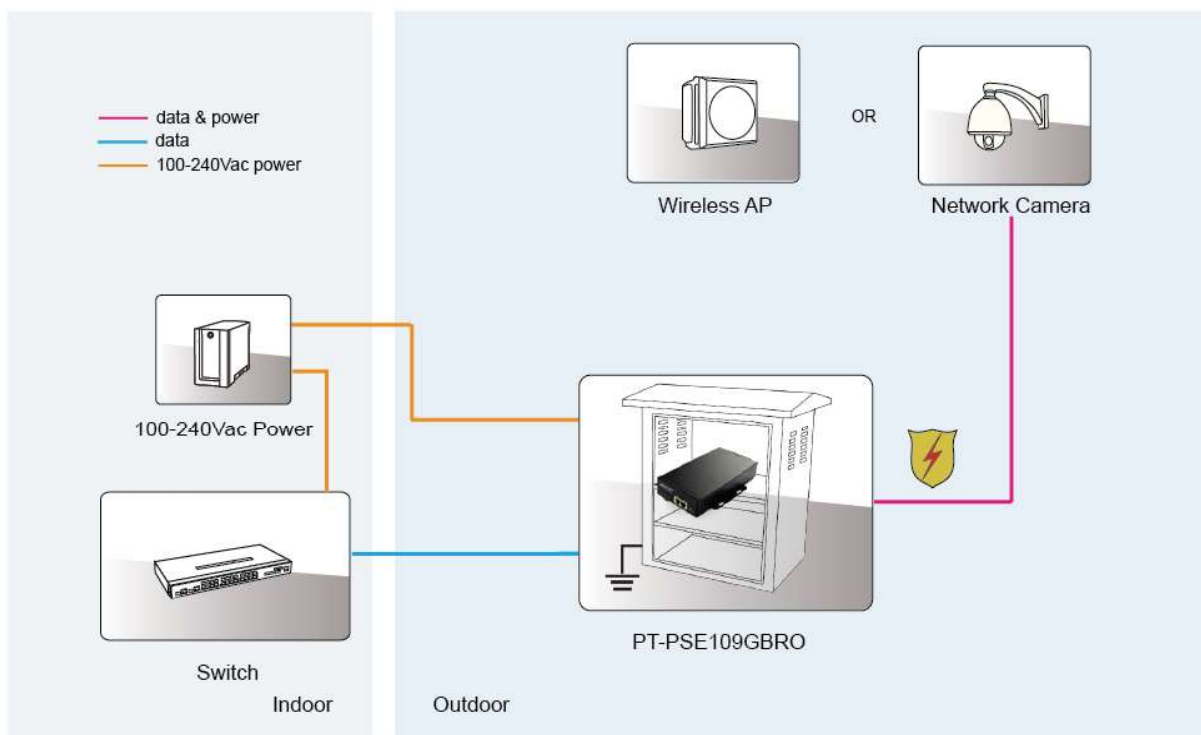

Specification

Standard

- IEEE802.3 10Base-T Ethernet
- IEEE802.3u 100Base-Tx Fast Ethernet
- IEEE802.3ab 1000Base-T Gigabit Ethernet
- Full compliant with IEEE802.3af/at, PoE++
- RoHS Compliance
- WEEE Compliance

Input & Output

- Input :100-240Vac 2.0A 50/60Hz
- Output: 55Vdc 1750mA
- Power Pins: 4/5(+), 7/8(-) and 3/6(+), 1/2(-)
- Data Speed: 10/100/1000Mbps

Working Environment

- Operating Temperature: -40℃ to 65℃
- Operating Humidity: 20% to 80%, non-condensation
- Storage Temperature: -40℃ to 85℃
- Storage Humidity: 10% to 90%, non-condensation
- Operating Altitude: up to 5000meters

LED Indicator

- Power Indicator: Green
- PoE Load Indicator: Green

Performance Data

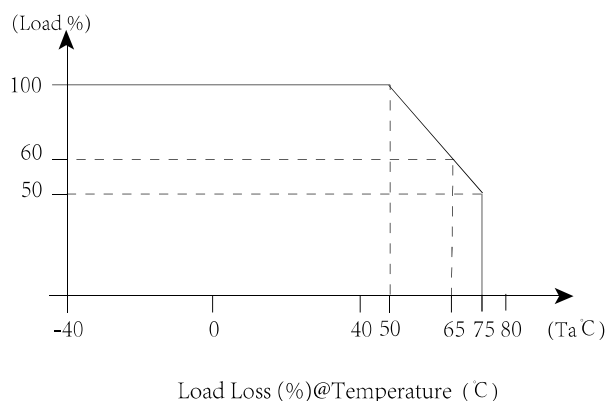

Safety Approvals

- cUL/UL
- CB
- RCM
- CE
- FCC
- NOM

AC Surge Protection

- Line-Earth 1.2/50us (8/20us): 2KV
- Line-Line 1.2/50us (8/20us): 1KV

PoE Surge Protection

- Protected line: 1,2,3,4,5,6,7,8
- Common mode surge protection(10/700us): 6KV
- Differential mode surge protection (10/700us): 1.5KV

Mechanical Characteristics

- Case: Metal
- Color: Black
- Mounting: Wall-mounted
- IP Rated: IP20
- Size: 214mm X 134mm X 41mm
- Weight: 1070g

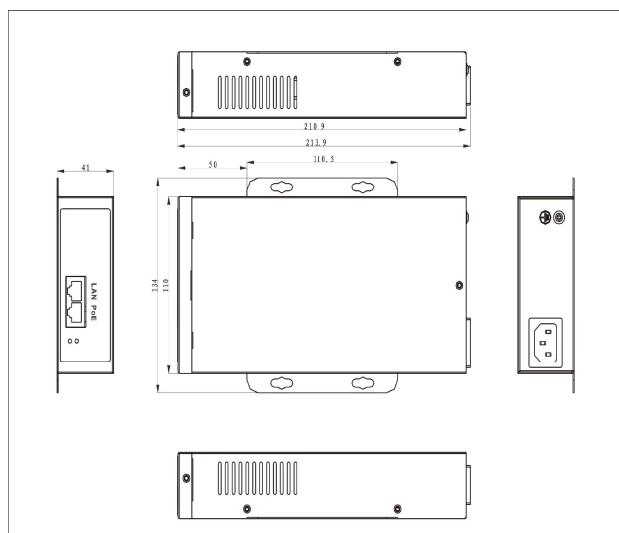

Order Info.

PT-PSE109GBRO 55Vdc/95W/1000Mbps/(4,5+,7,8-) and (3,6+,1,2-)/6KV Surge protection/Active

Packing

PT-PSE109GBRO x 1
Power Cord x 1 (Optional)
Operation Manual x 1



This document belongs to PROCET company. It is not allowed to reproduce and modify without the original author's permission. It is PROCET's policy to improve its products as new technology, components, software, and firmware at any time. PROCET, therefore, reserves the right to change specifications without prior notice. (2019.04)